

# SPRING DRIVEN CABLE REEL SERIES F 6947 / F 6948

Modular design for maximum flexibility



Moog is a global leader in the development and production of highly specialized electromechanical systems for the transmission of energy and data in mobile machines and devices.

Our portfolio includes robust spring-driven cable reels designed for the demanding environments of construction equipment and crane systems. The cable reels ensure reliable transmission of electrical power, signals, and data. The drive springs - manufactured from texture rolled spring steel - deliver exceptional durability and maintain consistent spring force throughout their lifecycle.

Our configurable drum system allows us to cover a wide range of customer specifications:

- Variable external dimensions, winding lengths, and spring forces
- Flexible cable and connector configurations
- Various cable guides and mounting adapters
- Optional integration of sensor systems, such as angle encoders for length measurement, and much more

Moog's flexible design allows us to configure and customize durable solutions for your specific application and meet the energy and signal transmission requirements for construction machinery, work platforms, and crane systems.

Contact us today to speak with an engineer about your application and select the optimal cable reel for your project.

## Features

- Maximum flexibility with a modular design
- Large reeling lengths possible with small drum installation space
- Housing parts designed for harsh environmental conditions
- Maintenance free for more than 10 million slip ring revolutions
- Up to 100,000 drum cycles possible, depending on configuration

## APPLICATIONS

- Construction machinery
- Mobile cranes
- Stationary cranes
- Work platforms
- Many other industrial applications



# SPECIFICATIONS

Series F 6947 / F 6948

|                          |  |
|--------------------------|--|
| <b>Curret rating</b>     | mA up to 32 A, data transmission (e.g. Ethernet, Profinet, CanBus)   |
| <b>Voltage Rating</b>    | 60 V / 500 V (AC / DC)   |
| <b>Travel Speed</b>      | Up to 1m/s (higher speeds on request)                                |
| <b>Temperature Range</b> | - 40 up to +80 °C  |
| <b>Protection Class</b>  | Slip ring: up to IP6K9K, components: sea water, UV and oil resistant |

| Dimensions *              |                |                              |                         |                        |                |
|---------------------------|----------------|------------------------------|-------------------------|------------------------|----------------|
| Reeling Length ***<br>[m] | Reel Type      | Reeling Diameter<br>Ø d [mm] | Reeling Width<br>b [mm] | Side Panel<br>Ø D [mm] | Spring Modules |
| 10                        | 20 33 09 10 2B | 202                          | 85                      | 330                    | 1              |
| 20                        | 20 33 12 2S 2B | 202                          | 120                     | 330                    | 2              |
| 20                        | 30 50 09 10 3B | 302                          | 85                      | 500                    | 1              |
| 40                        | 30 50 12 2S 3B | 302                          | 120                     | 500                    | 2              |
| 60                        | 30 50 16 3S 3B | 302                          | 155                     | 500                    | 3              |
| 80                        | 30 50 19 4S 3B | 302                          | 190                     | 500                    | 4              |

\* Other dimensions upon request.

\*\* Length of housing "a" related to number of poles and amperage.

\*\*\* Reeling length calculated for a cable Ø 8—12 mm and horizontal or vertical upwards application.

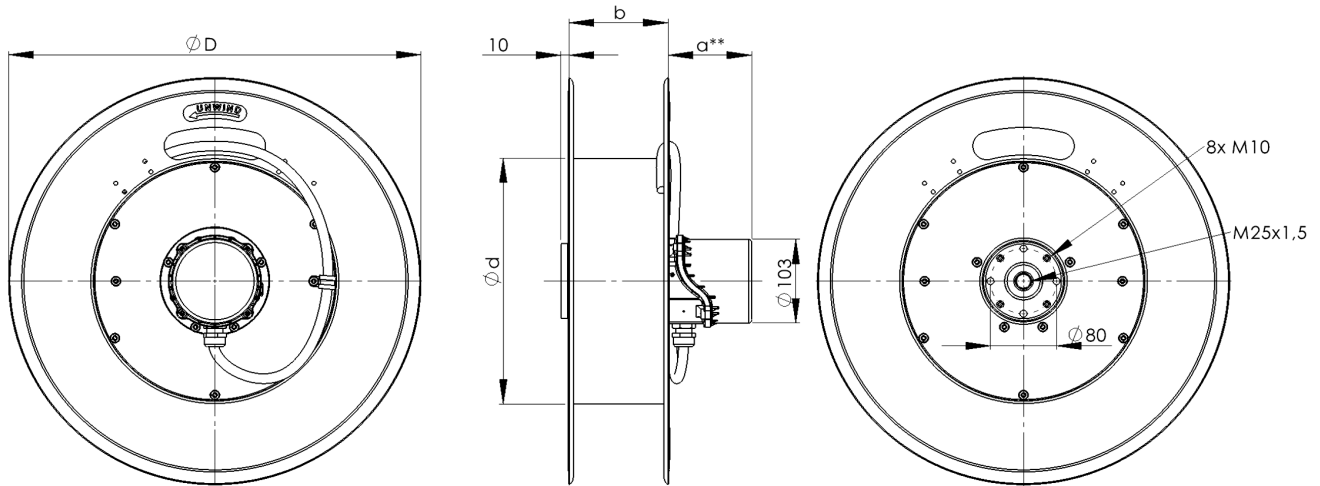

Dimensions in millimeters

For product information contact us online: [rekofa.info@moog.com](mailto:rekofa.info@moog.com)

Moog and Rekofa are registered trademarks of Moog Inc. and its subsidiaries. All trademarks as indicated herein are the property of Moog Inc. and its subsidiaries. ©2026 a Moog company. All rights reserved. All changes are reserved.

Moog Cable Reel F 6947 and F 6948 Datasheet  
MCM/Rev. -, March 2026, Id. CDL67025-en

This technical data is based on current available information and is subject to change at any time. Specifications for specific systems or applications may vary.